





BV Fa. Gartenkonzept Neubau Betriebsgelände, Maschinenhalle mit Aufenthaltsräumen und Bürogebäude

-  Asphalt
-  Betonpflaster, Schwerverkehr
-  Versickerungsaktiver Belag
-  Plattenbelag aus Naturstein Großformat
-  Betonpflaster Großformat

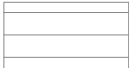

Adlerstraße 29 / 76133 Karlsruhe

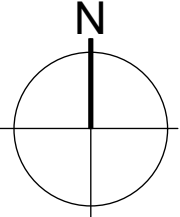
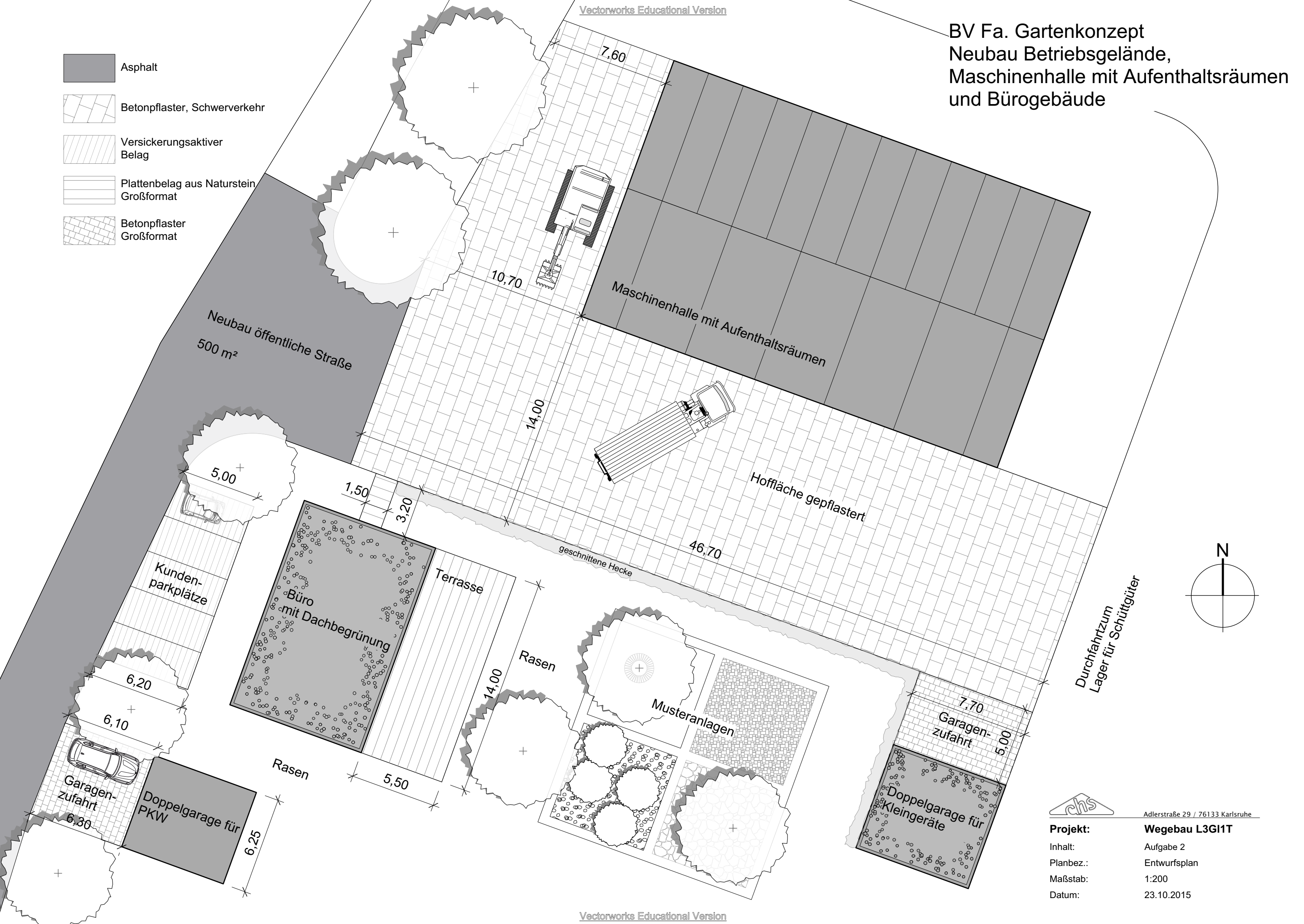
Projekt: Wegebau L3G11T
Inhalt: Aufgabe 2
Planbez.: Entwurfsplan
Maßstab: 1:200
Datum: 23.10.2015